

Stormwater Management Plan summary



SMP Title	Belmont Special Housing Area Stormwater Management Plan
SMP Date	December 2014
SMP Version	R001v2
SMP prepared by	Harrison Grierson
Location	North of Victoria Street West, Pukekohe
Consolidated Receiving Environment	Manukau Harbour
Stormwater Catchment	Whangapouri Creek
Brownfield / Greenfield	Greenfield
SMP Purpose	Plan Change
Auckland Unitary Plan Precinct	No precinct
Legacy NDC	R/VCC/2014/5334
Date Adopted into Regionwide NDC	15 September 2020
Healthy Waters Reference	NDC-2020-045

Stormwater management requirements

Stormwater Management Catchment	Proposed Land Use	Receiving Environment	Water Quality Management	Hydrology Mitigation (Retention)	Hydrology Mitigation (Detention)	Flood Management	Outlet Design	Assets to be Vested with Council	General Comments
A1, A2, D1	<ul style="list-style-type: none"> Residential Mixed Housing Suburban Zone 	Whangapouri Creek for catchments A, B, C, D, E, H, G, I.	<ul style="list-style-type: none"> Water quality treatment via at source retention and detention devices 	<ul style="list-style-type: none"> 10mm retention at source for all land use types 	<ul style="list-style-type: none"> 25mm detention for all land use types 	<ul style="list-style-type: none"> 10 and 100 year peak flow attenuation 	<ul style="list-style-type: none"> Stormwater Code of Practice 	<ul style="list-style-type: none"> Road reserve devices Attenuation basins Stormwater reticulation 	<ul style="list-style-type: none"> For catchment D1, piped 100 year flow from basin outlet (i.e. no overland flow)
G, I1, I2, H, E, F, C, B1, B2	<ul style="list-style-type: none"> Open Space - Informal Recreation Zone Residential Mixed Housing Suburban Zone 	Whangapouri Creek for catchments A, B, C, D, E, H, G, I.	<ul style="list-style-type: none"> Water quality treatment via at source retention and detention devices 	<ul style="list-style-type: none"> 10mm retention on private lots 10mm retention at source for all road runoff 	<ul style="list-style-type: none"> 25mm detention on private lots 25mm detention in winter wet basins for all road runoff 	<ul style="list-style-type: none"> 2, 10 and 100 year peak flow attenuation in each attenuation basin 	<ul style="list-style-type: none"> Stormwater Code of Practice 	<ul style="list-style-type: none"> Road reserve devices Attenuation basins Stormwater reticulation 	

Belmont Stormwater Management Plan Summary

Stormwater Management Catchment	Proposed Land Use	Receiving Environment	Water Quality Management	Hydrology Mitigation (Retention)	Hydrology Mitigation (Detention)	Flood Management	Outlet Design	Assets to be Vested with Council	General Comments
F and J	<ul style="list-style-type: none"> Residential Mixed Housing Suburban Zone 	Catchments F and J to unnamed stream AUP number: 438145	<ul style="list-style-type: none"> Water quality treatment via at source retention and detention devices. 	<ul style="list-style-type: none"> 10mm retention on private lots 10mm retention at source for all road runoff 	<ul style="list-style-type: none"> 25mm detention on private lots 25mm detention in winter wet basins for all road runoff See design concept for winter wet basins 	<ul style="list-style-type: none"> 2, 10 and 100 year peak flow attenuation in communal basin(s) for each sub-catchment as shown on below map. 	<ul style="list-style-type: none"> Stormwater Code of Practice 	<ul style="list-style-type: none"> Road reserve devices Stormwater reticulation 	<ul style="list-style-type: none">

Notes:





This SMP was prepared to support the Belmont Special housing area application in 2014. The SMP was incorporated into the Pukekohe North NDC (R/VCC/2014/5334) by s127 variation in June 2015.

This document is prepared to provide a summary of the stormwater management requirements within the adopted Stormwater Management Plan. To see the full Stormwater Management Plan please contact HWDevelopment@aucklandcouncil.govt.nz

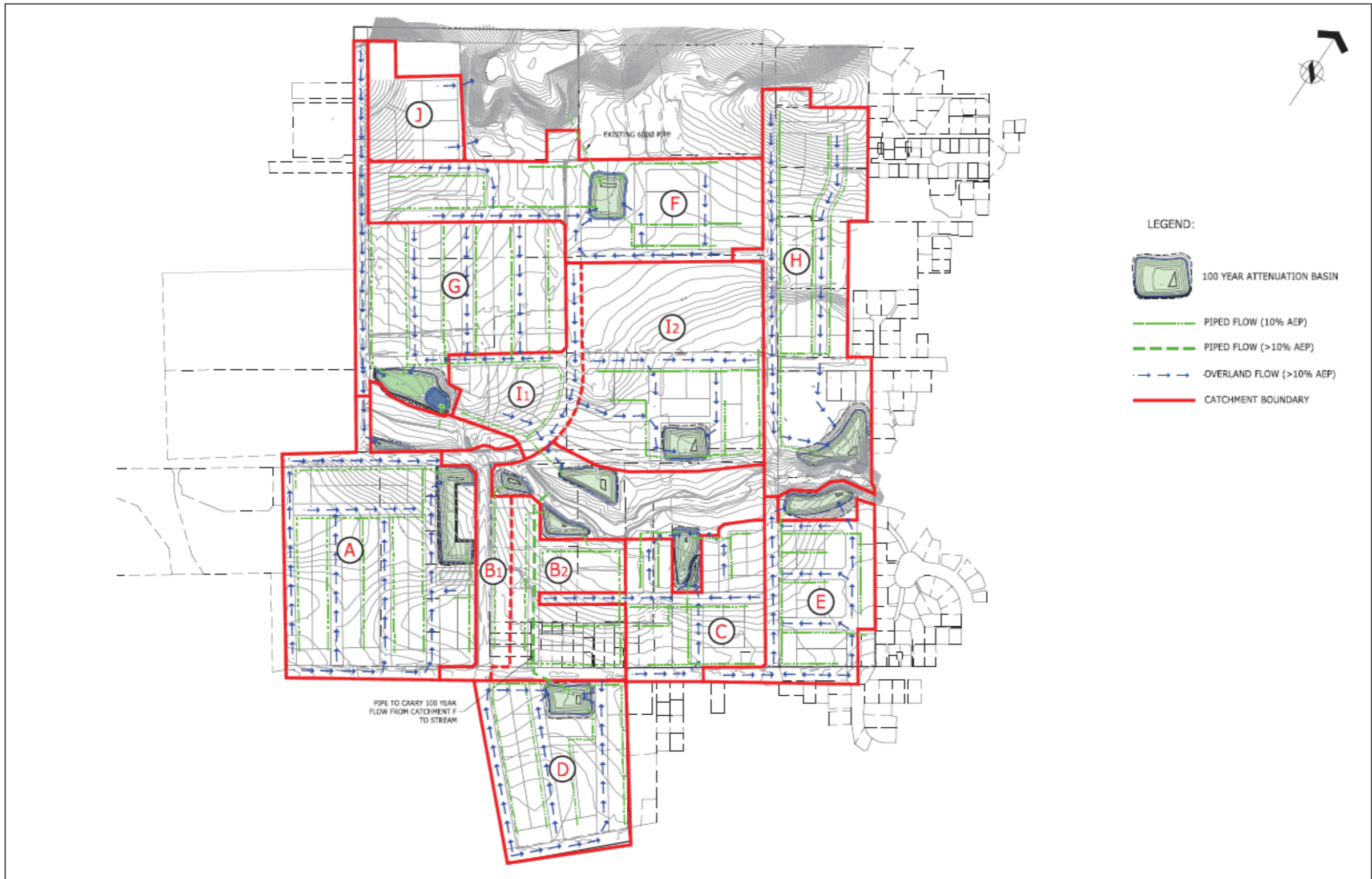
Belmont Stormwater Management Plan Summary

Catchment map



- LEGEND:**
-  100 YEAR ATTENUATION BASIN
 -  PIPED FLOW (10% AEP)
 -  PIPED FLOW (>10% AEP)
 -  OVERLAND FLOW (>10% AEP)
 -  CATCHMENT BOUNDARY

DESIGNER: MSG		DATE: 09/2014	DESIGNED BY: MSG	DATE: 09/2014	PROJECT NO: 126958	 ASSOCIATION OF CONSULTING ENGINEERS NEW ZEALAND  HIGGINS & GIBSON ASSOCIATION OF CONSULTING ENGINEERS NEW ZEALAND 100 WHEAT STREET AUCKLAND 1010 T: +64 9 556 2300 F: +64 9 556 2300 WWW.HIGGINSANDGIBSON.COM	PROJECT: BELMONT STRUCTURE PLAN STORMWATER MANAGEMENT PLAN	TITLE: STORMWATER CATCHMENTS WITH OVERLAND FLOW PATHS AND INDICATIVE PIPE NETWORK	ISSUE DATE: FOR INFORMATION		
DRAWN BY: MSG		DATE: 09/2014	CHECKED BY: MSG		DATE: 09/2014				PROJECT No: 126958-02 DRAWING No: 126958-02-52	SCALE: 1:2000 REV: 1	
1. PER INFORMATION REVISIONS		DATE: BY:	DATE: BY:	DATE: BY:	DATE: BY:	DATE: BY:	DATE: BY:	DATE: BY:	DATE: BY:		