

Stormwater Management Plan summary



SMP Title	Crows Road Special Housing Area Stormwater Management Plan
SMP Date	May 2016
SMP Version	R003v11
SMP prepared by	Harrison Grierson
Location	Betweeen Crows Road and Birdwood Road, Swanson
Consolidated Receiving Environment	Waitemata Harbour
Stormwater Catchment	Swanson
Brownfield / Greenfield	Greenfield
SMP Purpose	Plan Change/Subdivision
Unitary Plan Precinct	Chapter I 7.12 Birdwood 2
Legacy NDC	REG-2016-1301 (Crows Road NDC)
Date SMP Adopted	January 2021
HW Reference	2021-01

Stormwater management requirements

Stormwater management catchment	Proposed land use	Receiving environment	Water quality management	Hydrology mitigation (retention)	Hydrology mitigation (detention)	Flood management	Outlet design	Assets to be vested with council	General comments
Pond/Basin A	<ul style="list-style-type: none"> Residential – Single House Residential - Mixed Housing Suburban Zone 	Momutu Stream	Water quality treatment for all roads via at source retention devices* (5mm WQV)	Retention at source (5mm)	Detention in basin	1% AEP attenuation in inter wet basin	Stormwater code of practice	<ul style="list-style-type: none"> Stormwater reticulation and outfalls Winter wet basins Road reserve devices 	
Pond/Basin B	<ul style="list-style-type: none"> Residential – Single House Residential - Mixed Housing Suburban Zone 	Momutu Stream	Water quality treatment for all roads via at source retention devices* (5mm WQV)	Retention at source (5mm)	Detention in basin	1% AEP attenuation in inter wet basin	Stormwater code of practice	<ul style="list-style-type: none"> Stormwater reticulation and outfalls Winter wet basins Road reserve devices 	

Crows Road Stormwater Management Plan Summary

Stormwater management catchment	Proposed land use	Receiving environment	Water quality management	Hydrology mitigation (retention)	Hydrology mitigation (detention)	Flood management	Outlet design	Assets to be vested with council	General comments
Direct Stream Discharge (residential lots)	Residential – Single House Residential - Mixed Housing Suburban Zone	Momutu Stream	Water quality treatment for all roads via at source retention devices* (5mm WQV)	Retention at source (5mm)	Detention at source	Over attenuation for 100yr event in Winter wet basins to compensate for Lots not draining to a basin.	Waitakere City Councils Countryside and Foothills Code of Practice for private discharge to the stream	<ul style="list-style-type: none"> N/A 	Basin A has been designed to 'over attenuate' to accommodate the impervious areas for lots discharging directly the stream. Therefore, no at source mitigation required.

Notes:

* Water quality for the stream catchments C2 and C3 shall be met through the provision of the Hydrology management requirements which provide a suitable level of quality treatment.

This SMP was prepared to support the Crows Road Special Housing Area application in 2016. The Crows Road NDC (REG-2016-1301) was granted in August 2016.

This document is prepared to provide the user with a summary of the stormwater management requirements within the adopted Stormwater Management Plan. To see the full Stormwater Management Plan please contact HWDevelopment@aucklandcouncil.govt.nz

Crows Road Stormwater Management Plan Summary

Catchment map

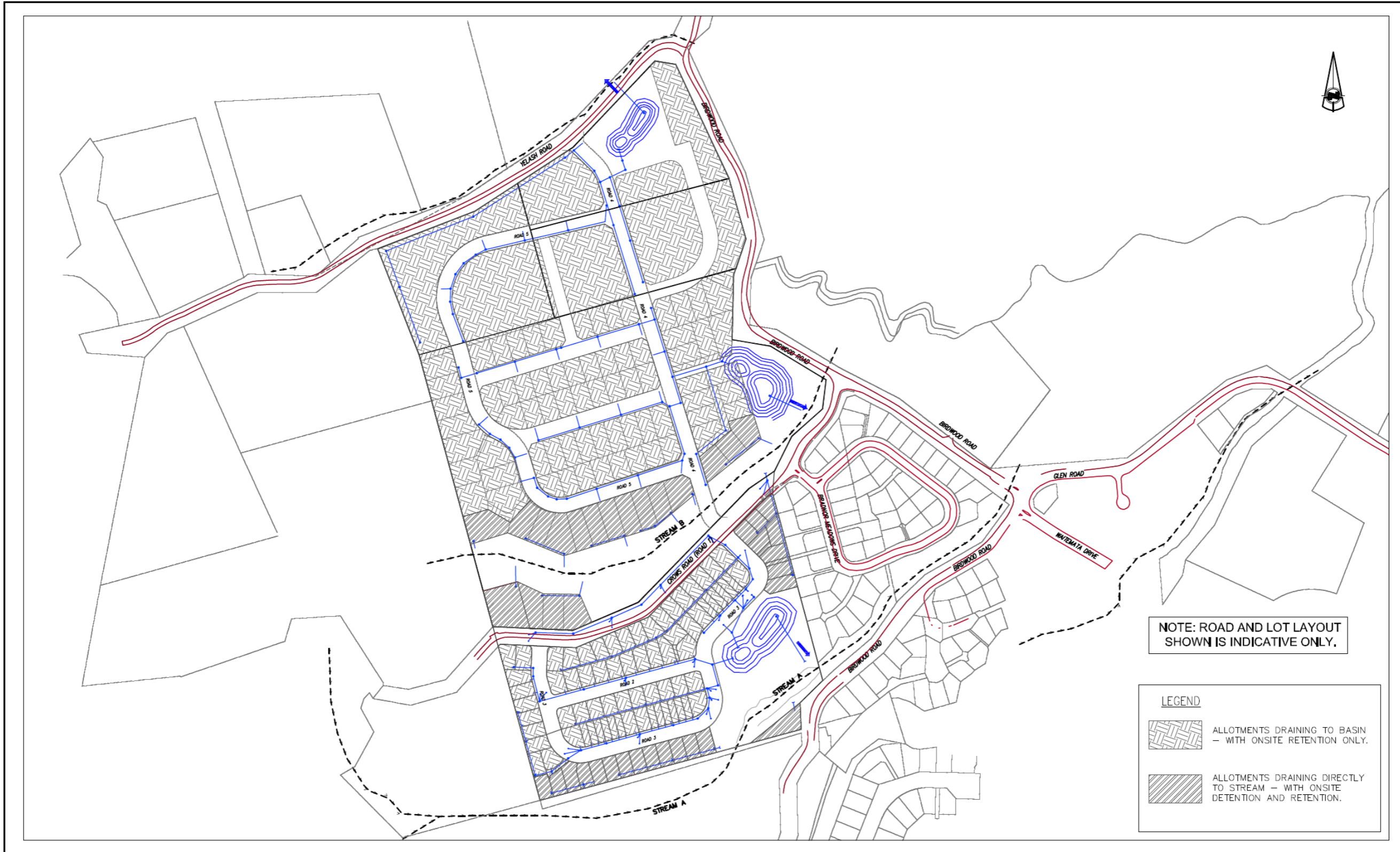

NOTE: ROAD AND LOT LAYOUT SHOWN IS INDICATIVE ONLY.

LEGEND

- ALLOTMENTS DRAINING TO BASIN - WITH ONSITE RETENTION ONLY.
- ALLOTMENTS DRAINING DIRECTLY TO STREAM - WITH ONSITE DETENTION AND RETENTION.

Rev	Description	By	Date
B	AC PV COMMENTS	CK	04/16
A	PV AC COMMENTS	CK	04/16

THE DRAWING AND DESIGN REMAINS THE PROPERTY OF
NEIL CONSTRUCTION LIMITED
 LAND DEVELOPERS
 PO BOX 8751, SYMONDS STREET
 AUCKLAND, NEW ZEALAND
 TELEPHONE: +64 9 918 6565
 FACSIMILE: +64 9 918 6567
 WEB: www.neilgroup.co.nz

Job Title
CROWS ROAD SWANSON PLAN VARIATION

Drawing Title
STORMWATER DRAINAGE ALLOTMENT MANAGEMENT 10YR

By	Date	Scale	Job No.	Rev
DS / HH		1:2000 @A1	Drawing No.	
CK		1:4000 @A3	428-PV-SW-404	B
CK	04/16			
CAD FILE: F:\PROJECTS\CROWS ROAD\DWG\Plan Variation\428-PV-SW-400-499.dwg				